

Dimensions

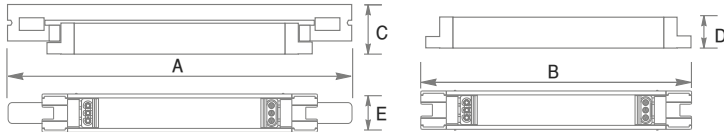

	A (inch)	B (inch)	C (inch)	D (inch)	E (inch)
14/24W	22 7/8	19 6/8	1 6/8	1 1/16	1 5/8
21/39W	34 11/16	31 5/8	1 6/8	1 1/16	1 5/8
28/54W	46 4/8	43 3/8	1 6/8	1 1/16	1 5/8

	Model No.	Lamp power (watt)	Voltage
High Efficiency	DSLL14AB23NN	14	110-130
	DSLL21AB23NN	21	110-130
	DSLL28AB23NN	28	110-130
High Output	DSLL24AB23NN	24	110-130
	DSLL39AB23NN	39	110-130
	DSLL54AB23NN	54	110-130

Mounting

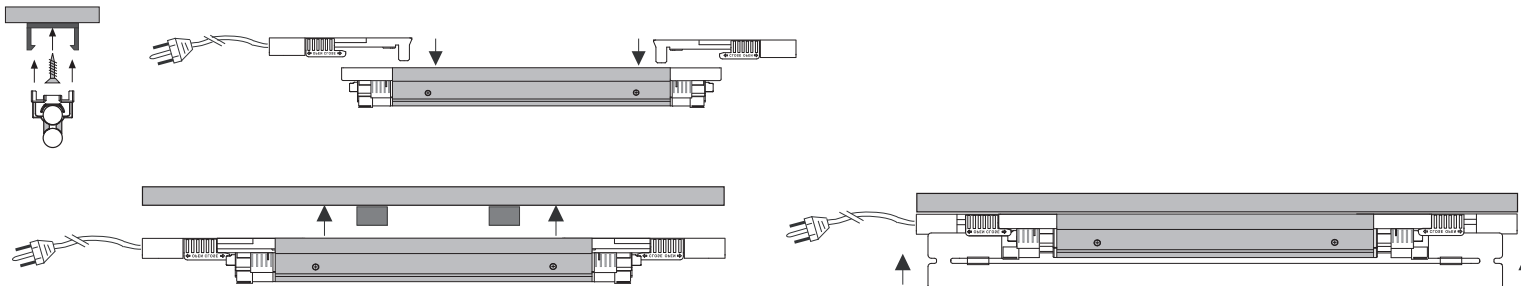

Specification

Frequency range	60Hz
Voltage	110-130V
Power factor	>97%
Color rendering	Ra>80
A-THD	<15%
Class of protection	I
Degree of protection	IP20
Output protocol	PWM
Dimming range	5~100%

Accessories

- (a)
 - DSLLOPC120/XL connecting cable 6feet (1800mm)
 - DSLLOPC1/XL connecting cable 1feet (300mm)
 - DSLLOPC2/XL connecting cable 2feet (600mm)
 - DSLLOPC4/XL connecting cable 4feet (1200mm)
 - (Between DimslimLine(in) & Dimming Controller(out) w/o plug)
- (b)
 - SLLCPL/XL
 - direct connecting cap
- (c)
 - DSLLPTC/XL connecting cable 6inch (150mm)
 - DSLLPTC1/XL connecting cable 1feet (300mm)
 - DSLLPTC2/XL connecting cable 2feet (600mm)
 - DSLLPTC4/XL connecting cable 4feet (1200mm)
 - DSLLPTC6/XL connecting cable 6feet (1800mm)
- (d)
 - SLL-OUTLET CAP
 - protecting cap for termination

Connection

