

DATE

PROJECT

TYPE



PRODUCT FEATURES

- Flexible luminaire with optics
- Fully sealed with PU material for wet location
- IP67 rated for outdoor and indoor application.
- Various beam angles(30°, 45°, 60°, 20x45°)
- 90+ CRI Standard
- Dimmable
- Field Cuttable 125mm (4.92") for customized length
- 18W per meter (5.5W/ft)

PRODUCT SPECIFICATIONS

IP Rate	IP67
Lamp Power	18W/m (5.5W/ft)
Power Input	24V DC
Color Rendering	Ra>90
Operating Temperature Ranges	-25°C to 45°C (-13°F to 113°F)
Maximum Length	5,000mm (16.4')
Minimum Length	125mm (4.92")
Minimum Bending Diameter	150mm (5.90")
Beam Angle	30°, 45°, 60°, 20x45°
Material	PU

SPECIFICATIONS TABLE



Model Number	Color	Lamp Power	Luminous Flux (lm/m)	Lumen/W
FTT18-27K-24V-C90	2,700K	18W/m (5.5W/ft)	1,544 lm/m	85.78lm/W
FTT18-30K-24V-C90	3,000K		1,576 lm/m	88.33lm/W
FTT18-35K-24V-C90	3,500K		1,544 lm/m	87.76lm/W
FTT18-40K-24V-C90	4,000K		1,563 lm/m	89.06lm/W

Note
Beam Angle: 30°, 45°, 60°, 20°x45° available lens options

BENDING DIAMETER

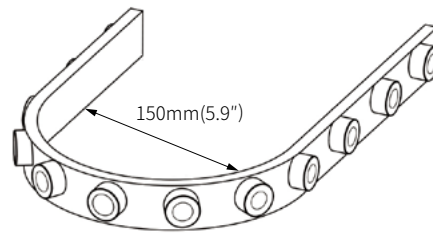

BEAM SPREADS

FTT18 30K-24V-C90-30
87.67 lm/W
1,578.06lm

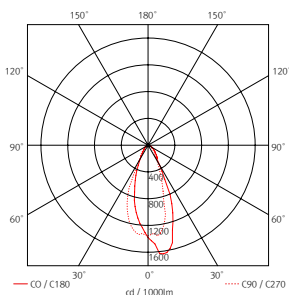

FTT18 30K-24V-C90-45
88.76 lm/W
1,570lm

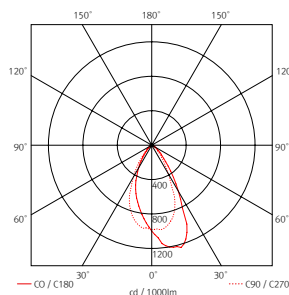

FTT18 30K-24V-C90-60
88.33 lm/W
1,575.50lm

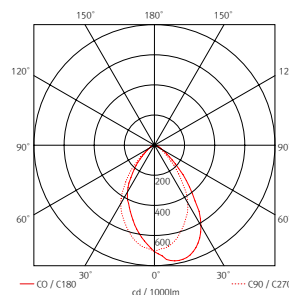

FTT18 30K-24V-C90-20x45
79.25 lm/W
1,394.20lm

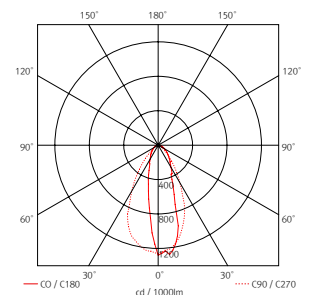

DIMENSION

Available in Standard Lengths of 1,2,3,4,5M reels

OPC Type

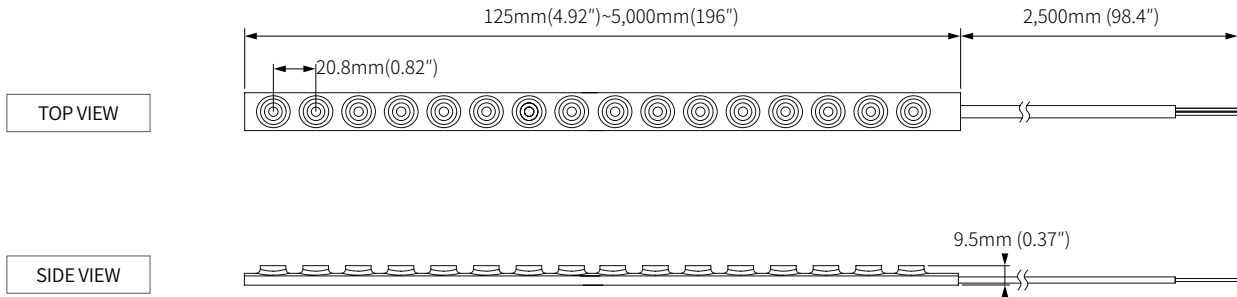

Add-on Type

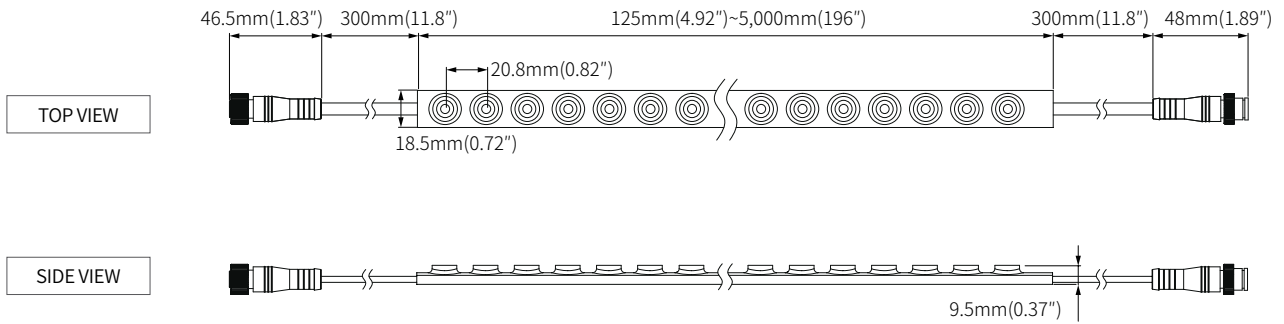

End Type

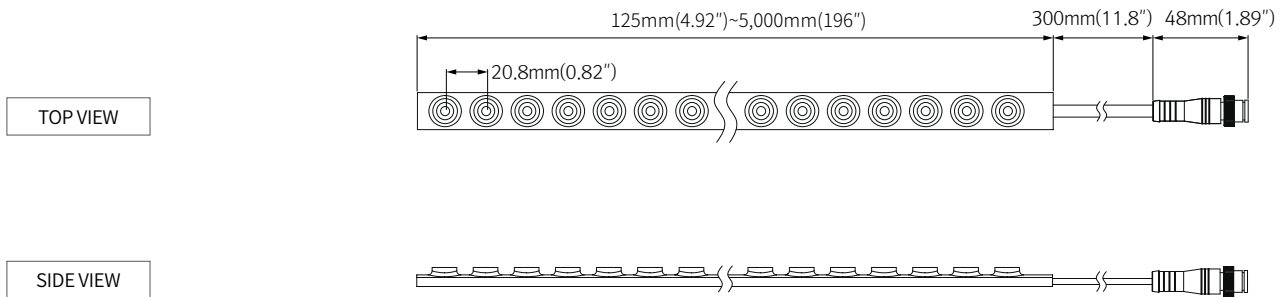

INSTALLATION

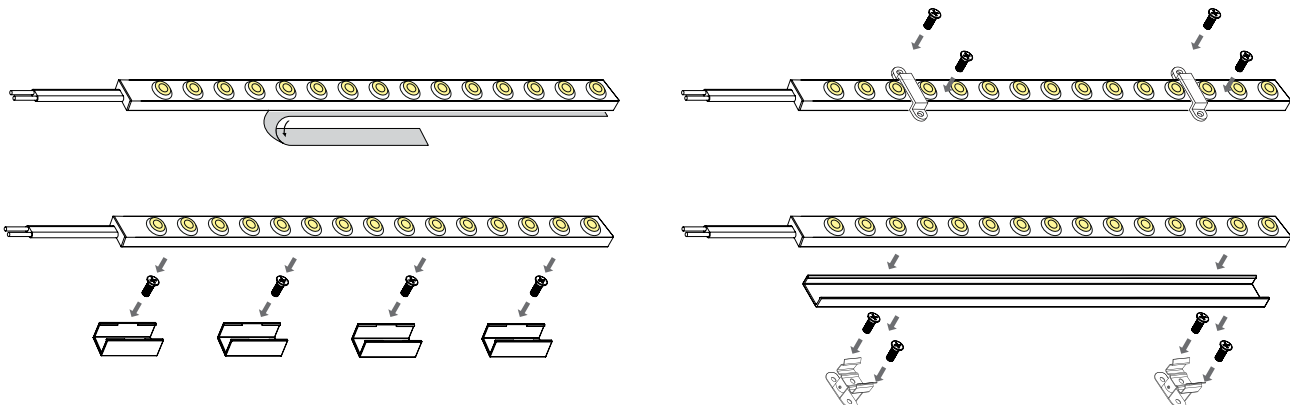

COMPONENTS



FLXible Tape Tako (OPC Type)

- __FTT18-(color)K-24V-C90 (5M)
- __FTT18-(color)K-24V-C90 (4M)
- __FTT18-(color)K-24V-C90 (3M)
- __FTT18-(color)K-24V-C90 (2M)
- __FTT18-(color)K-24V-C90 (1M)



FLXible Tape Tako (Add-on Type)

- __FTT18A-(color)K-24V-C90 (5M)
- __FTT18A-(color)K-24V-C90 (4M)
- __FTT18A-(color)K-24V-C90 (3M)
- __FTT18A-(color)K-24V-C90 (2M)
- __FTT18A-(color)K-24V-C90 (1M)



FLXible Tape Tako (End Type)

- __FTT18B-(color)K-24V-C90 (5M)
- __FTT18B-(color)K-24V-C90 (4M)
- __FTT18B-(color)K-24V-C90 (3M)
- __FTT18B-(color)K-24V-C90 (2M)
- __FTT18B-(color)K-24V-C90 (1M)



FTT Angle Bracket

- __FTT-BRAKET2 (1set = 2pcs)

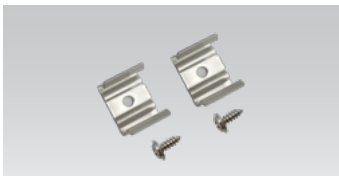

FTT Bracket

- __FTT-BRAKET1 (1set = 2pcs)

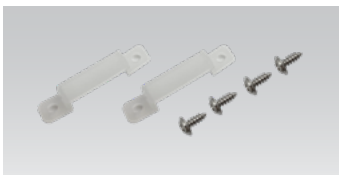

FTT Strap

- __FTT-STRAP (1set = 10pcs + 20screws)

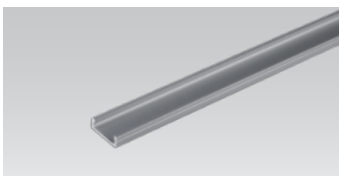

FTT Extrusion Line

- __FTT-EXL(1M)

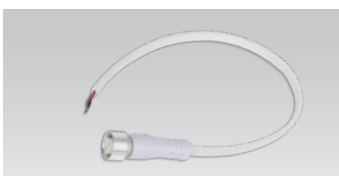

Power Cable

- __FTTPC (2,500mm / 8.2')



Male and Female Connector

- __FTTPC (150mm / 6")
- __FTTPC1 (300mm / 1')
- __FTTPC2 (600mm / 2')
- __FTTPC4 (1,200mm / 4')
- __FTTPC6 (1,800mm / 6')

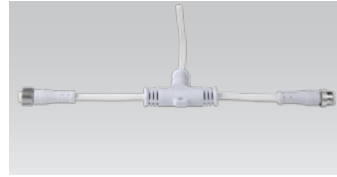

T-Type Connector

- __FTTPC-T (200mm / 7.87")
- 2 way female connector

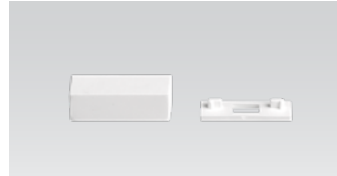

END CAP

- __FTT-END CAP



LED Drivers

- __FLC30-24V/T
- __FLC75-24V/T
- With distributor and powercord
- 1,800mm (6')



LED Drivers

- __FLC200-24V/T
- with 12way distributor



Dimming Interface

- __FDC-L10
- Max. 100W (100W/CH, 1CH)
- 0 -10V Signal



Dimming Interface

- __FDA-L2MO
- (0-10V/1-10V. DMX512)
- Max. 200W (100W/CH, 2CH)
- __FDA-L5M
- Max. 200W (50W/CH, 5CH)



Dimming Interface (Dail)

- __FDD-L1DA
- Max. 200W (100W/CH, 1CH)