

FLXible LED Tape

High flexibility Led tape for various application

Illuminate Your Space with LED Flexible Tape



- Various wattage option available
- Easy installation with adhesive tape
- Field cuttable for customized length
- Flexible strip covered with soft silicon sleeve
- To be used with constant voltage DC24V driver
- RGBWW version available (Dimmable)

Without silicon sleeve type (Optional)

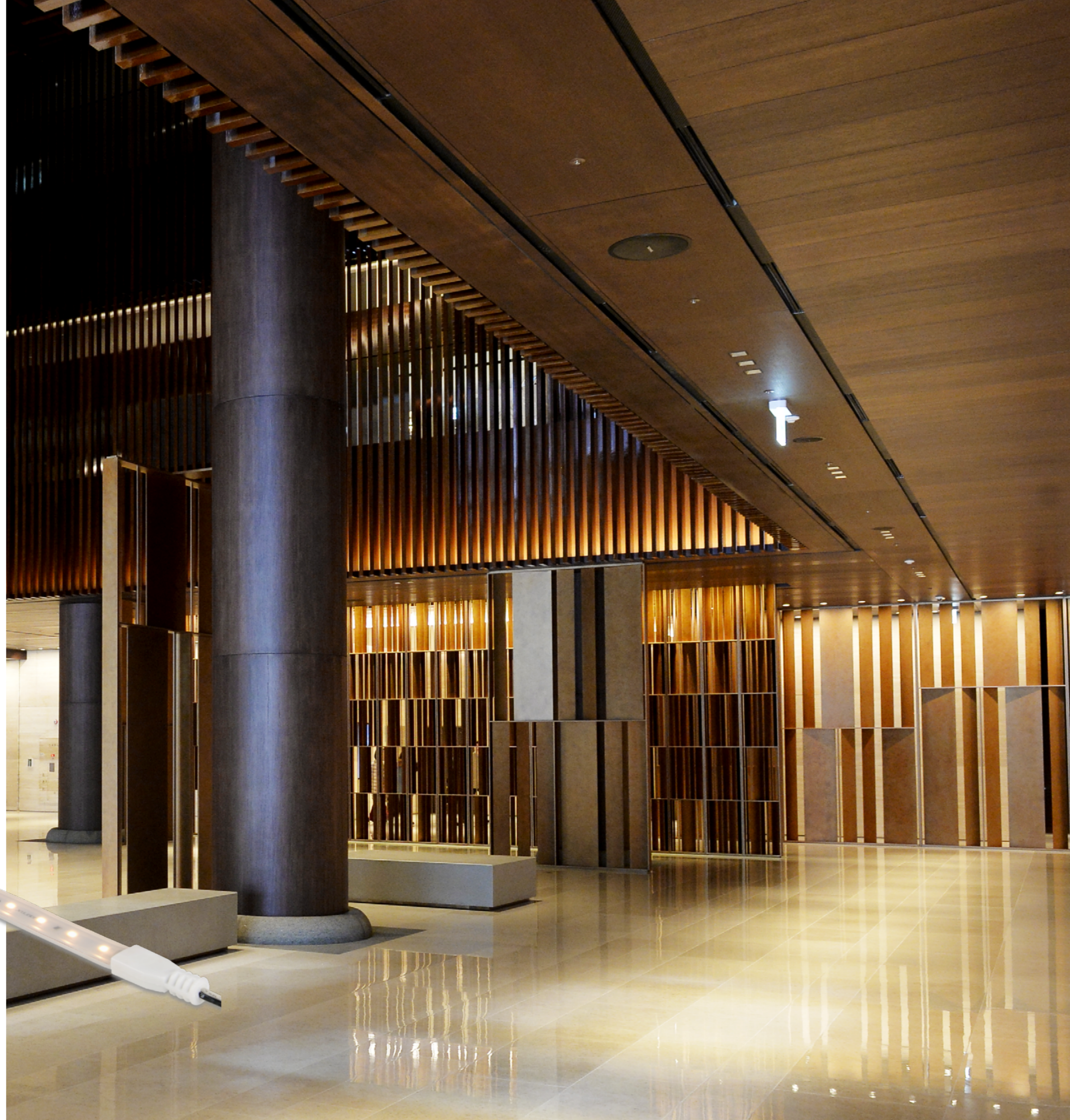
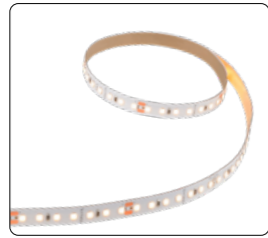



Specification

Model Name	Power Input	Lamp Power	Lumens	Efficiency	Color Rendering	Available Color	Operating temperature	IP	Type
FTS5 40K-24V	DC 24V	4.5 W	480 lm	107 lm/W	Ra > 90	2,700K/3,000K/3,500K/4,000K	0 ~ 45°C	IP66	Sleeve type
FTS8 40K-24V	DC 24V	7.5 W	730 lm	104 lm/W	Ra > 90	2,700K/3,000K/3,500K/4,000K	0 ~ 45°C	IP66	
FTS10 40K-24V	DC 24V	9.5 W	1,010 lm	101 lm/W	Ra > 90	2,700K/3,000K/3,500K/4,000K	0 ~ 45°C	IP66	
FTS15 40K-24V	DC 24V	15 W	1,515 lm	101 lm/W	Ra > 90	2,700K/3,000K/3,500K/4,000K	0 ~ 45°C	IP66	
FT5 40K-24V	DC 24V	4.5 W	520 lm	116 lm/W	Ra > 90	2,700K/3,000K/3,500K/4,000K	0 ~ 45°C	IP20	Non - sleeve type
FT8 40K-24V	DC 24V	7.5 W	790 lm	113 lm/W	Ra > 90	2,700K/3,000K/3,500K/4,000K	0 ~ 45°C	IP20	
FT10 40K-24V	DC 24V	9.5 W	1,100 lm	110 lm/W	Ra > 90	2,700K/3,000K/3,500K/4,000K	0 ~ 45°C	IP20	
FT15 40K-24V	DC 24V	15 W	1,650 lm	110 lm/W	Ra > 90	2,700K/3,000K/3,500K/4,000K	0 ~ 45°C	IP20	

Dimension

*Silicon sleeve type (FTS5, FTS8, FTS10)

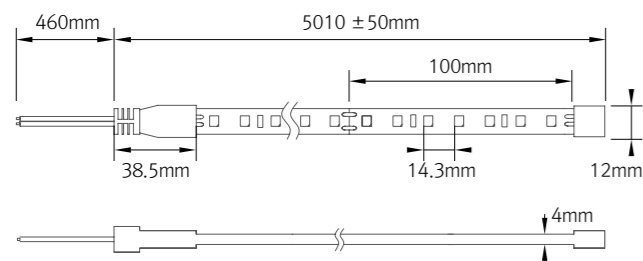

*Silicon sleeve type (FTS15)

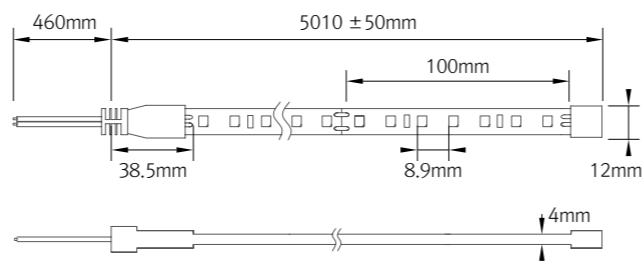

Installation

Bracket Installation

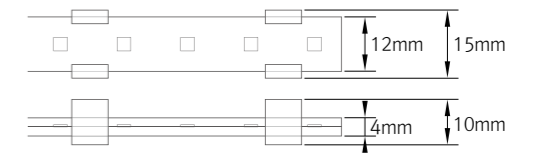
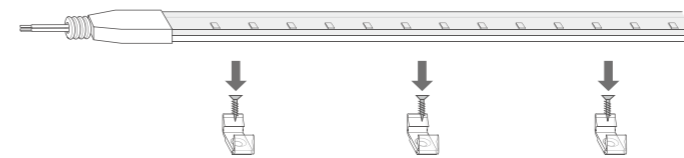

3M Glue Installation

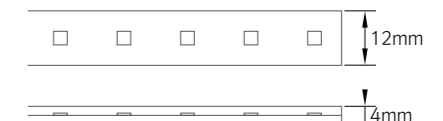
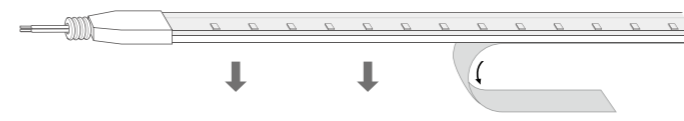

Accessories

a Sleeve type

- FTS5 40K-24V [5M] : 4.5W
- FTS8 40K-24V [5M] : 7.5W
- FTS10 40K-24V [5M] : 9.5W
- FTS15 40K-24V [5M] : 15W

b Power cord for sleeve type : FTSPC

c Direct connector for sleeve type : FTSCPL

d Without Sleeve type

- FT5 40K-24V [5M] : 4.5W
- FT8 40K-24V [5M] : 7.5W
- FT10 40K-24V [5M] : 9.5W
- FT15 40K-24V [5M] : 15W

e Power cord for non-sleeve type : FTPC

f Direct Connector for non-sleeve type : FTCPL

g Mounting brackets: FTS-BRACKET

h LED Driver with 12way distributor, with power cord (1,800mm)

Part No	FLC30-24V/T	FLC75-24V-P/T
Capacity	30W 24V	75W 24V

i LED Driver : FLC200-24V/T (200W DC24V)

LED Driver With 12way distributor

j Dimming Interface (1-10V) : FDC-L10

Max. 100W (100W/CH, 1CH)

k Dimming Interface (0-10/1-10, DMX512)

FDA-L2M0 : Max. 200W (100W/CH, 2CH)
 FDA-L5M : Max. 200W (50W/CH, 5CH)

l Dimming Interface (Dali) : FDD-L1DA

Max. 200W (100W/CH, 1CH)

